

CITRUS™



Simple, fresh, and clean modern design. Citrus™ is a seating solution for lab and healthcare environments that doesn't force you to choose between style and performance. Its Flex Function™ back and waterfall edge seat auto-adjust to individual users, while its one-touch height adjustment allows for easy sanitation.

SPECIFICATIONS

FEATURES

- Flex Function back and forward edge seat adapt and auto-adjust to individual user movements and support perching or sitting postures
- One-touch height adjustment-is the only user-made adjustment necessary
- Minimal joint hygienic design for easy cleaning and disinfection
- Meets BIFMA Healthcare Furniture Cleanability Guidelines HCF 8.1-2019
- ISO-Class 3 cleanroom rated
- 300lb weight capacity
- SCS Indoor Advantage Gold Certification and may help contribute toward LEED certification

CONSTRUCTION

- Simple design and minimalist construction with few moving parts
- Robust Polyamide shell with glass fiber-reinforced polypropylene backrest for improved flexibility and strength
- Plush synthetic leather or durable integral skin foam seat with anti-bacterial properties
- Class 4 pneumatic cylinder

OPTIONS

- Casters: multi-surface dual wheel is standard. Other caster options are also available
- High-performance twist-lock flat surface chrome footring. Footrings are only available on high-height stools
- Desk and high height with desk to counter option
- Durable nylon or polished aluminum base
- Fixed arms option available
- Available in five colors or ESD: Anthracite* (gray), Sky* (blue), White*, Orange, Lime (green), and Onyx (black - ESD only). *5 day lead time on Anthracite (gray), Sky (blue), and White.

DIMENSIONS

MODEL#	MAXIMUM OVERALL DIMENSIONS		SEAT DIMENSIONS		SEAT HEIGHT FROM FLOOR WHEN SEATED E	BACK DIMENSIONS		WEIGHT LBS.
	A	B	C	D		F	G	
CTD	36.50	25.50	17.50	16.25	16.00 - 22.00	16.00	14.50	16
CTH	45.50	25.50	17.50	16.25	20.75 - 31.00	16.00	14.50	22
CTRD	22.00	25.50	15.75	15.75	16.00 - 22.00	-----	-----	17
CTRH	31.00	25.50	15.75	15.75	20.75 - 31.00	-----	-----	22

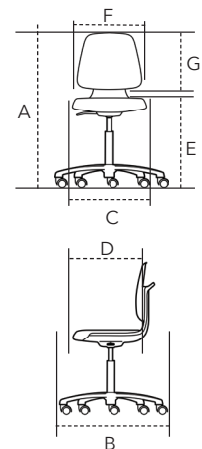

Dimensions listed in inches.
Adding arms will increase weight by 6.5 lbs.