

CITRUS™



Simple, fresh, and clean modern design. Citrus™ is a seating solution for lab and healthcare environments that doesn't force you to choose between style and performance. Its Flex Function™ back and waterfall edge seat auto-adjust to individual users, while its one-touch height adjustment allows for easy sanitation.

SPECIFICATIONS

FEATURES

- Flex Function back and forward edge seat adapt and auto-adjust to individual user movements and support perching or sitting postures
- One-touch height adjustment-is the only user-made adjustment necessary
- Minimal joint hygienic design for easy cleaning and disinfection
- Meets BIFMA Healthcare Furniture Cleanability Guidelines HCF 8.1-2019
- ISO-Class 3 cleanroom rated
- 300lb weight capacity
- SCS Indoor Advantage Gold Certification and may help contribute toward LEED certification

CONSTRUCTION

- Simple design and minimalist construction with few moving parts
- Robust Polyamide shell with glass fiber-reinforced polypropylene backrest for improved flexibility and strength
- Plush synthetic leather or durable integral skin foam seat with anti-bacterial properties
- Class 4 pneumatic cylinder

OPTIONS

- Casters: multi-surface dual wheel is standard. Other caster options are also available
- High-performance twist-lock flat surface chrome footring. Footrings are only available on high-height stools
- Desk and high height with desk to counter option
- Durable nylon or polished aluminum base
- Fixed arms option available
- Available in five colors or ESD: Anthracite* (gray), Sky* (blue), White*, Orange, Lime (green), and Onyx (black - ESD only). *5 day lead time on Anthracite (gray), Sky (blue), and White.

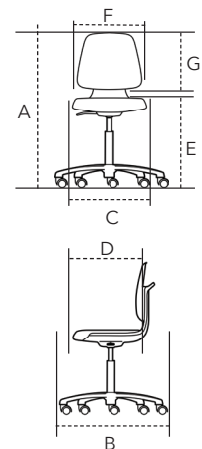

DIMENSIONS

MODEL#	MAXIMUM OVERALL DIMENSIONS		SEAT DIMENSIONS		SEAT HEIGHT FROM FLOOR WHEN SEATED E	BACK DIMENSIONS		WEIGHT LBS.
	A	B	C	D		F	G	
CTD	36.50	25.50	17.50	16.25	16.00 - 22.00	16.00	14.50	16
CTH	45.50	25.50	17.50	16.25	20.75 - 31.00	16.00	14.50	22
CTRD	22.00	25.50	15.75	15.75	16.00 - 22.00	-----	-----	17
CTRH	31.00	25.50	15.75	15.75	20.75 - 31.00	-----	-----	22





Dimensions listed in inches.
Adding arms will increase weight by 6.5 lbs.

PRICING: CITRUS

	Chair Style	Seat Material	Adjustment Mechanism	Shell Color	Model Number	List Price
Desk		Synthetic Leather	One-Touch	Anthracite	CTDL1	\$850
				Sky	CTDL2	
				White	CTDL3	
				Orange	CTDL4	
				Lime	CTDL5	
	Integral Foam	One-Touch	Anthracite	CTDU1	\$850	
			Sky	CTDU2		
			White	CTDU3		
	Integral ESD Foam	One-Touch	Onyx	CTDE6	\$1,290	
High		Synthetic Leather	One-Touch	Anthracite	CTHL1	\$950
				Sky	CTHL2	
				White	CTHL3	
				Orange	CTHL4	
				Lime	CTHL5	
	Integral Foam	One-Touch	Anthracite	CTHU1	\$950	
			Sky	CTHU2		
			White	CTHU3		
	Integral ESD Foam	One-Touch	Onyx	CTHE6	\$1,390	

One-Touch Adjustment Mechanism - Seat Height

*ESD - standard with polished aluminum base and chrome cylinder (option E)

	Chair Style	Seat Material	Adjustment Mechanism	Model Number	List Price
Desk		Integral Skin	One-Touch	CTRDU	\$610
High		Integral Skin	One-Touch	CTRHU	\$740

One-Touch Adjustment Mechanism - Seat Height

OPTIONS:

ORDER CODE LIST PRICE

CASTERS

- 2 multi-surface dual wheel standard**
- 3 non-rolling glide \$32
(not available for ESD models)
- 7 weight-activated brakes when not seated \$120
(not available for ESD models)

ARMS

- A fixed arms \$170
(not available for ESD models)

** Standard casters and footing included unless different options are requested.

***5 day lead time on Anthracite (gray), Sky (blue), and White.

ORDER CODE LIST PRICE

FOOTRINGS

- flat surface chrome footing standard**
(only available on high height)

EXTRAS

- E polished aluminum base and chrome cylinder \$125
(standard option on ESD)
- L desk to counter cylinder (approx. 17.5" - 25") \$55
(cylinder upcharge added to high-height price) \$55
**not available on ESD models

HOW TO ORDER

MODEL NUMBER	AVAILABLE OPTIONS CODE
<input style="width: 100%; height: 20px;" type="text"/>	<input style="width: 100%; height: 20px;" type="text"/>