

FUSION® FUSION® R+

10
YEAR
THREE-SHIFT
WARRANTY



The Fusion series is our most flexible line with dozens of configurable options and available with R+ Technology - our patented polyurethane cover system. This versatility makes Fusion our best-selling line that can fill a variety of roles in both lab and technical environments.

SPECIFICATIONS

FEATURES

- Heavy-duty steel seat for multi-shift durability
- Available in our patented R+ upholstery system - urethane resists tears, punctures and virtually all spills
- Contoured molded seat with waterfall edge ensures 24-hour comfort
- Dynamic range of adjustments support the full range of seated postures from active forward-leaning to recline
- High performance twist-lock footing with 20" diameter (on stool heights)
- Supports up to 350 lbs
- 10-Year, Three-Shift Warranty
- SCS Indoor Advantage Gold Certification and may help contribute toward LEED certification
- Supports up to 350 lbs
- R+ meets BIFMA Healthcare Furniture Cleanability Guidelines HCF 8.1-2019

CONSTRUCTION

- 27.25" fiberglass-reinforced nylon base
- 16-gauge steel seat pan
- Integrated steel arm structure with metal-to-metal connections eliminates points of failure
- High resiliency 3" thick seat foam with a density of 2.4 lbs. per cubic foot
- Class 4 pneumatic cylinder: 1.12" diameter with a 17-4 taper top end for maximum strength
- Heat-bonded powder coat finish

OPTIONS

- Arms: an intensive use fixed arm option, an adjustable arm option, or a fully articulating arm option
- Casters: multi-surface dual wheel is standard. A variety of other casters are also available
- High-performance twist-lock footings: rounded chrome is standard. Flat surface chrome, XL flat surface black 22" or fixed (desk height only) are also available
- Desk, mid, desk-to-counter, high, and extended range heights
- Painted or polished aluminum base (27.75")
- ISO Class 5 Cleanroom (Fed Std 209 Class 100)
- ESD, or CR/ESD Combination
- Mesh back available as an option (4-Way mechanism only)



- Patented R+ combination of urethane and molded foam provides a comfortable seat
- Resists punctures, tears and virtually all spills; and cleans easily with bleach or ethanol
- Textured surface prevents slipping
- Rhino Plus properties: tear strength of 17.7 kgF, puncture resistance of 9.9 kgF, stretch of 660%, abrasion resistance of 25,000 and a Ross Flex rating of 150,000 flexes

DIMENSIONS

MODEL#		MAXIMUM OVERALL DIMENSIONS		SEAT DIMENSIONS		SEAT HEIGHT FROM FLOOR WHEN SEATED E	BACK DIMENSIONS		WEIGHT LBS.
		A	B	C	D		F	G	
RPMD2	FSMD2	37.50	27.50	19.50	19.50	17.25 - 22.50	16.75	15.00	30
RPMM2	FSMM2	45.25	27.50	19.50	19.50	21.50 - 29.00	16.75	15.00	35
RPMH2	FSMH2	50.00	27.50	19.50	19.50	23.50 - 33.75	16.75	15.00	35

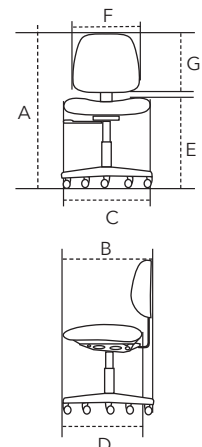

Dimensions listed in inches.
Adding arms will increase weight by 10 lbs.

Measurements are for standard mechanisms and can vary +/- .5".
Seat slider and arm options can increase overall height and seat height .25" -1"

PRICING: FUSION & FUSION R+

			FUSION R+		FUSION							
Chair Style	Back Size	Adjustment Mechanism	Model Number	List Price	Model Number	List Price by Textile Grades (see textile card for styles)						ESD*
						1	2	3	4	5	6	
Desk	M	2 Way	RPMD2	\$848	FSMD2	\$820	\$836	\$852	\$878	\$920	\$980	\$965
		4 Way	RPMD4	\$945	FSMD4	\$919	\$935	\$951	\$977	\$1,019	\$1,079	\$1,064
		6 Way	RPMD6	\$1,035	FSMD6	\$1,023	\$1,039	\$1,055	\$1,081	\$1,123	\$1,183	\$1,168
		7 Way	RPMD7	\$1,073	FSMD7	\$1,036	\$1,052	\$1,068	\$1,094	\$1,136	\$1,196	---
Mid	M	2 Way	RPM2	\$947	FSM2	\$928	\$944	\$960	\$986	\$1,028	\$1,088	\$1,073
		4 Way	RPM4	\$1,042	FSM4	\$1,005	\$1,021	\$1,037	\$1,063	\$1,105	\$1,165	\$1,150
		6 Way	RPM6	\$1,094	FSM6	\$1,080	\$1,096	\$1,112	\$1,138	\$1,180	\$1,240	\$1,225
		7 Way	RPM7	\$1,174	FSM7	\$1,140	\$1,156	\$1,172	\$1,198	\$1,240	\$1,300	---
High	M	2 Way	RPMH2	\$964	FSMH2	\$947	\$963	\$979	\$1,005	\$1,047	\$1,107	\$1,092
		4 Way	RPMH4	\$1,063	FSMH4	\$1,028	\$1,044	\$1,060	\$1,086	\$1,128	\$1,188	\$1,173

R+ Color Options - 252 Black, 256 ESD Black, 282 Graphite, 262 Sky, 272 Fern

2 Way - Seat Height, Back Depth

4 Way - Seat Height, Back Height, Back Angle, Seat Angle

6 Way - Seat Height, Back Height, Back Angle, Seat Angle, Chair Tilt, Forward Tilt Limiter

7 Way - Seat Height, Back Height, Back Angle, Seat Angle, Chair Tilt, Forward Tilt Limiter, Seat Depth

*Must indicate ESD textile code AND option code R or Q below for chair to perform as ESD

OPTIONS:

ORDER CODE LIST PRICE

CASTERS

- 2 multi-surface dual wheelstandard**
- 1 carpeted floor only..... n/c
- 3 non-rolling glide..... n/c
- 4 hard surface single wheel\$66
- 5 glide / caster combination
3x glides, 2x multi-surface..... \$66
- 9 weight activated brakes when seated.....\$130
- 10 hard surface single wheel with 3" diameter \$66

ARMS

- B adjustable arms\$175
- T articulating arms.....\$190
- A intensive use fixed arms\$250



*ESD not available for option codes 1, 4, 10, D, H, L, T, W, Y or 7 way mechanism
 **Standard casters and footings included unless different options are requested.
 ***Limited availability of mesh back

ORDER CODE LIST PRICE

FOOTRINGS

- rounded chrome footingstandard**
- X flat surface chrome footing (20") \$38
- C fixed footing (18" - desk height only)..... \$55
- W XL flat surface black footing (22") \$45

ENVIRONMENTS

- P cleanroom (must choose vinyl or R+ model)..... \$90
- Q ESD* (must choose ESD textile or R+ 256 black) (includes flat surface chrome footing and polished aluminum base)..... \$200
- R cleanroom/ESD (must choose ESV vinyl or R+ 256 black) ... \$220

EXTRAS

- D 27.75" painted aluminum base \$63
 - E 27.75" polished aluminum base \$78
 - K upholstered outer back (unavailable in R+)..... \$80
 - M extended range cylinder (approx. 21.25"-31.25")
(cylinder upcharge added to mid-height price)..... \$30
 - L desk to counter cylinder (approx. 17.5" - 25")
(cylinder upcharge added to mid-height price)..... \$50
 - Y Fusion mesh back option
(only available on 4-way models) \$230
 - H Fusion mesh back with headrest
(only available on 4-way models) \$420
- ***Limited availability of mesh back options

HOW TO ORDER

MODEL NUMBER	TEXTILE CODE*	AVAILABLE OPTIONS CODE
<input type="text"/>	<input type="text"/>	<input type="text"/>

*Refer to Cramer Textile Offering for code. (COM priced at Grade 3)