

HELIX™



Meet Helix, the future of modern lab and caregiver seating. Its patent-pending Frameless Back™ hugs the user, providing total support and unmatched freedom of motion. Its seamless seat and back cushions are perfect for clean environments and the organic form brings a modern sensibility to progressive healthcare and lab facilities.

SPECIFICATIONS

FEATURES

- Patent-pending Frameless Back™ adapts organically to the user, providing exceptional freedom of motion and comfort
- One-touch adjustment ensures a fast, personal fit for multiple users
- Seamless i+™ Polyurethane cushions resist contaminants and will withstand hospital cleaning agents
- Streamlined form minimizes the visual impact and doesn't interrupt sightlines
- Meets BIFMA Healthcare Furniture Cleanability Guidelines HCF 8.1-2014
- 300lb weight capacity

CONSTRUCTION

- i+™ Polyurethane seat and back
- Advanced thermoplastic elastomer flexing upright
- Heavy-duty formed steel mechanism
- Resilient glass fiber support spring
- 26" Durable nylon base
- Class 4 Cylinder

OPTIONS

- High-performance twist-lock flat surface steel 22" black footring. Footrings are only available on high-height
- Casters: multi-surface dual wheel is standard. Non-rolling glides are also available
- Desk and high-height with desk-to-counter option
- Available in five colors: Slate (dark grey), Stone (light grey), Citrine (yellow), Aquamarine (blue), Coral



DIMENSIONS

MODEL#	MAXIMUM OVERALL DIMENSIONS		SEAT DIMENSIONS		SEAT HEIGHT FROM FLOOR WHEN SEATED E	BACK DIMENSIONS		WEIGHT LBS.
	A	B	C	D		F	G	
HXDU	42.00	26.50	18.50	16.75	16.25 - 21.50	18.00	17.25	26.00
HXHU	53.50	26.50	18.50	16.75	23.00 - 33.00	18.00	17.25	33.00

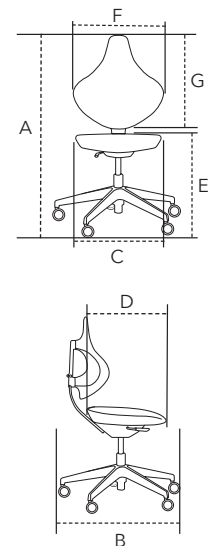
Dimensions listed in inches.



PRICING: HELIX

	Chair Style	Seat Material	Adjustment Mechanism	Upright Color	Model Number	List Price
Desk		i+™ Polyurethane	One-Touch	Slate	HXDU1	\$920
				Aquamarine	HXDU2	
				Stone	HXDU3	
				Coral	HXDU4	
				Citrine	HXDU5	
High		i+™ Polyurethane	One-Touch	Slate	HXHU1	\$1050
				Aquamarine	HXHU2	
				Stone	HXHU3	
				Coral	HXHU4	
				Citrine	HXHU5	

One-Touch Adjustment Mechanism - Seat Height

OPTIONS:

ORDER
CODE

LIST
PRICE

CASTERS

- 2 multi-surface dual wheelstandard**
- 3 non-rolling glide..... n/c

ARMS

- A Available Summer 2020

ORDER
CODE

LIST
PRICE

EXTRAS

- L Desk to counter cylinder (approx. 17.5" - 25")
.....(cylinder upcharge added to high-height price) \$50

** Standard casters and footings included unless different options are requested.

HOW TO ORDER

MODEL NUMBER	AVAILABLE OPTIONS CODE
<input style="width: 20px; height: 20px; border: 1px solid black;" type="text"/> <input style="width: 20px; height: 20px; border: 1px solid black;" type="text"/> <input style="width: 20px; height: 20px; border: 1px solid black;" type="text"/> <input style="width: 20px; height: 20px; border: 1px solid black;" type="text"/> <input style="width: 20px; height: 20px; border: 1px solid black;" type="text"/>	<input style="width: 20px; height: 20px; border: 1px solid black;" type="text"/> <input style="width: 20px; height: 20px; border: 1px solid black;" type="text"/> <input style="width: 20px; height: 20px; border: 1px solid black;" type="text"/> <input style="width: 20px; height: 20px; border: 1px solid black;" type="text"/> <input style="width: 20px; height: 20px; border: 1px solid black;" type="text"/>