

TRITON® TRITON® R+

15
YEAR
THREE-SHIFT
WARRANTY



Triton chairs have been engineered and built to withstand demanding Med-Tech environments and 24/7 usage. Triton and Triton R+ feature carbon steel frames, metal-to-metal assembly and come with a 15-year performance guarantee. This highly engineered construction delivers reliable performance and cleanability day after day.

SPECIFICATIONS

FEATURES

- Heavy-duty steel seat and back guarantee multi-shift durability
- Contoured molded seat with waterfall edge ensures 24-hour comfort
- Dynamic range of adjustments support the full range of seated postures from active forward-leaning to recline
- High performance 23.5" flat black sure-lock footring (on stool heights)
- Supports up to 350 lbs
- 15-Year, Three-Shift Warranty
- Triton has SCS Indoor Advantage Gold Certification and may help contribute toward LEED certification
- **NEW!** High-performance 23.5" flat surface black footring
- All metal construction

CONSTRUCTION

- 26" die-cast aluminum base
- 16-gauge steel seat pan
- 16-gauge pressed steel inner back plate with an 18-gauge outer shell
- Integrated steel arm structure with metal-to-metal connections eliminates points of failure
- High resiliency flame-retardant 3" thick seat foam with a density of 2.4 lbs. per cubic foot
- Class 4 pneumatic cylinder: 1.12" diameter with a 17-4 taper top end for maximum strength
- Heat-bonded powder coat finish

OPTIONS

- Arms: an intensive use fixed arm option; an adjustable arm option (height range of 6"-10" above seat, inside width range of 19.5"-23"); or a fully articulating arm option w/ slide (adds 3 locking pivot positions, and 2.5" of travel front to back)
- Casters: multi-surface dual wheel is standard. A variety of other casters are also available
- 23" flat black footring is standard (mid and high heights only) or fixed 18" chrome rounded (desk height only) also available
- Desk, mid, **NEW!** desk-to-counter, high, and extended range heights
- Upholstered outer back
- Polished aluminum base
- TB 133 Fire Code
- Class 100 Cleanroom
- ESD, or CR/ESD Combination
- FNEW83-269 E - includes 14-gauge steel seat pan

R+

- Patented Rhino Plus combination of urethane and molded foam provides a comfortable seat
- Resists punctures, tears and virtually all spills; and cleans easily with bleach or ethanol
- Textured surface prevents slipping
- Rhino Plus properties: tear strength of 17.7 kgF, puncture resistance of 9.9 kgF, stretch of 660%, abrasion resistance of 25,000 and a Ross Flex rating of 150,000 flexes

DIMENSIONS

MODEL#	MAXIMUM OVERALL DIMENSIONS		SEAT DIMENSIONS		SEAT HEIGHT FROM FLOOR WHEN SEATED E	BACK DIMENSIONS		WEIGHT LBS.
	A	B	C	D		F	G	
TPMD4 - 7	39.00	27.50	19.50	19.50	16.00 - 21.25	17.25	15.00	51
TPMM4	46.50	27.50	19.50	19.50	21.50 - 29.25	17.25	15.00	56
TPMH4	51.50	27.50	19.50	19.50	23.25 - 33.25	17.25	15.00	57
TRMD4 - 7	39.00	27.50	19.50	19.50	16.00 - 21.25	17.25	15.00	51
TRMM4	46.50	27.50	19.50	19.50	21.50 - 29.25	17.25	15.00	56
TRMH4	51.50	27.50	19.50	19.50	23.25 - 33.25	17.25	15.00	57
TRLD4 - 7	42.00	27.50	19.50	19.50	16.00 - 21.25	18.00	18.00	56
TRLM4	49.50	27.50	19.50	19.50	21.50 - 29.25	18.00	18.00	61
TRLH4	54.50	27.50	19.50	19.50	23.25 - 33.25	18.00	18.00	62

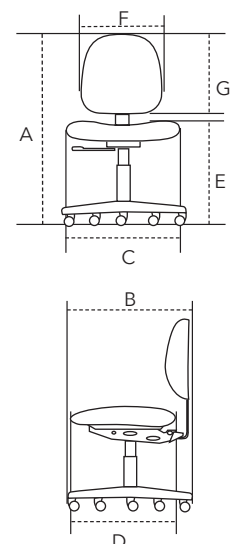

Dimensions listed in inches.
Adding arms will increase weight by 10 lbs.

Measurements are for standard mechanisms and can vary +/- .5".
Seat slider and arm options can increase overall height and seat height .25" -1"