

FUSION® ROUND STOOL

FUSION® ROUND STOOL R+



The Fusion Round Stool is a welcome addition to a busy work area. Not just for medical applications, this model is perfect anywhere a versatile, well-padded place to sit will make life a little easier.

SPECIFICATIONS

FEATURES

- Three seat heights
- Contoured foam seat ensures 24-hour comfort
- Hand or foot-activated height adjustment, accessible from any direction
- High performance sure-lock footring with 20" diameter (on hand-activated stool heights)
- Supports up to 350 lbs
- 10-Year, Three-Shift Warranty
- **NEW!** Now available with back

CONSTRUCTION

- 16-gauge steel seat pan
- 23" fiberglass-reinforced nylon base (hand-activated); 23" die-cast aluminum base (foot-activated)
- High resiliency flame-retardant 2.5" thick seat foam with a density of 2.4 lbs. per cubic foot
- Class 4 pneumatic cylinder
- Heat-bonded powder coat finish

OPTIONS

- Casters: multi-surface dual wheel is standard. A variety of other casters are also available
- Rounded chrome footring is standard. Flat surface chrome and fixed chrome (desk height only) is also available. Footrings are only available on hand-activated, mid and high-height stools
- Desk, mid, **NEW!** desk-to-counter, high, and extended range heights
- Textile or vinyl upholstery - also available with R+ Technology
- Painted or polished aluminum base
- TB 133 Fire Code (Fusion Round Stool only)
- Class 100 Cleanroom
- ESD, and CR/ESD Combination (hand-activated) (Fusion Round Stool only)

R+

- Patented Rhino Plus combination of urethane and molded foam provides a comfortable seat
- Resists punctures, tears and virtually all spills; and cleans easily with bleach or ethanol
- Textured surface prevents slipping
- Rhino Plus properties: tear strength of 17.7 kgF, puncture resistance of 9.9 kgF, stretch of 660%, abrasion resistance of 25,000 and a Ross Flex rating of 150,000 flexes

DIMENSIONS

MODEL# R+	MAXIMUM OVERALL DIMENSIONS		SEAT DIMENSIONS	SEAT HEIGHT FROM FLOOR WHEN SEATED	BACK DIMENSIONS		WEIGHT LBS.
	A	B	C	D	E	F	
RP0D1 RS0D1	20.50	24.50	16.00	15.50 - 20.75	---	---	23
RP0M1 RS0M1	27.75	24.50	16.00	20.25 - 27.75	---	---	25
RP0H1 RS0H1	32.75	24.50	16.00	22.75 - 32.75	---	---	26
RPBD1 RSBD1	20.50	24.50	16.00	15.50 - 20.75	17.00	12.00	23
RPBM1 RSBM1	27.75	24.50	16.00	20.25 - 27.75	17.00	12.00	25
RPBH1 RSBH1	32.75	24.50	16.00	22.75 - 32.75	17.00	12.00	26
RP0F1 RS0F1	23.00	24.50	16.00	17.25 - 22.25	---	---	23
RP0G1 RS0G1	29.50	24.50	16.00	21.25 - 28.50	---	---	25

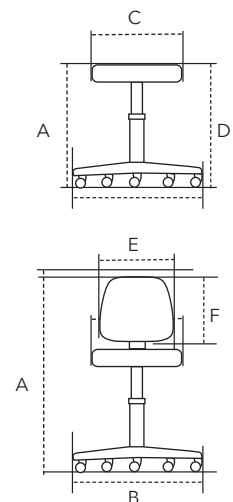

Dimensions listed in inches.