

# FUSION® FIT FUSION® FIT R+

**10**  
YEAR  
THREE-SHIFT  
WARRANTY



Smaller footprint, same performance. Fusion Fit follows the same construction as the Fusion series but in a more compact footprint, and available with R+ Technology - our patented polyurethane cover system. This makes Fusion Fit more versatile and can fill a variety of roles in both lab and technical environments.

## SPECIFICATIONS

### FEATURES

- Ergonomically proportioned to comfortably fit smaller individuals and tighter workspaces
- Available in our patented\* R+ technology
- Solid construction guarantees years of support
- Contoured molded seat with waterfall edge ensures 24-hour comfort
- Dynamic range of adjustments support the full range of seated postures from active forward-leaning to recline
- High performance sure-lock footring with 20" diameter (on stool heights)
- Supports up to 300 lbs
- 10-Year, Three-Shift Warranty
- Fusion Fit has SCS Indoor Advantage Gold Certification and may help contribute toward LEED certification
- Premium molded foam seat cushion

### CONSTRUCTION

- 23" fiberglass-reinforced nylon base
- 16-gauge steel seat pan
- Integrated steel arm structure with new shorter arm bar
- Class 4 pneumatic cylinder: 1.12" diameter with a 17-4 taper top end for maximum strength
- Heat-bonded powder coat finish

### OPTIONS

- Arms: an intensive use fixed arm option; an adjustable arm option (height range of 6"-10" above seat, inside width range of 19.5"-23"); or a fully articulating arm option w/ slide (adds 3 locking pivot positions, and 2.5" of travel front to back)
- Casters: multi-surface dual wheel is standard. A variety of other casters and glides are also available
- Rounded chrome footring is standard. Flat surface chrome (mid and high heights only) or fixed chrome (desk height only) are also available
- Desk, mid, **NEW!** desk-to-counter, high, and extended range heights
- Painted or polished aluminum base
- TB 133 Fire Code (Fusion Fit only)
- Class 100 Cleanroom
- ESD, or CR/ESD Combination

### R+

- Patented Rhino Plus combination of urethane and molded foam provides a comfortable seat
- Resists punctures, tears and virtually all spills; and cleans easily with bleach or ethanol
- Textured surface prevents slipping
- Rhino Plus properties: tear strength of 17.7 kgF, puncture resistance of 9.9 kgF, stretch of 660%, abrasion resistance of 25,000 and a Ross Flex rating of 150,000 flexes

### DIMENSIONS

MODEL#	MAXIMUM OVERALL DIMENSIONS		SEAT DIMENSIONS		SEAT HEIGHT FROM FLOOR WHEN SEATED E	BACK DIMENSIONS		WEIGHT LBS.
	A	B	C	D		F	G	
RPSD2 - 4	36.00	24.50	18.00	17.00	16.75 - 22.25	17.00	12.00	27
RPSM2 - 4	43.50	24.50	18.00	17.00	21.25 - 28.75	17.00	12.00	32
RPSH2 - 4	48.50	24.50	18.00	17.00	23.00 - 33.50	17.00	12.00	33
FFSD2 - 4	36.00	24.50	18.00	17.00	16.75 - 22.25	17.00	12.00	27
FFSM2 - 4	43.50	24.50	18.00	17.00	21.25 - 28.75	17.00	12.00	32
FFSH2 - 4	48.50	24.50	18.00	17.00	23.00 - 33.50	17.00	12.00	33

R+

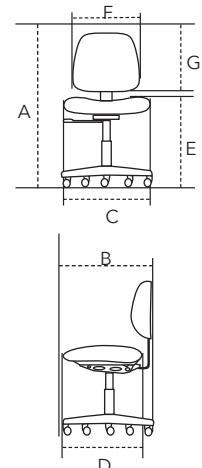

Dimensions listed in inches.  
Adding arms will increase weight by 10 lbs.

Measurements are for standard mechanisms and can vary +/- .5".